

HIGHWAYS AT BLETCHLEY IN MILTON KEYNES

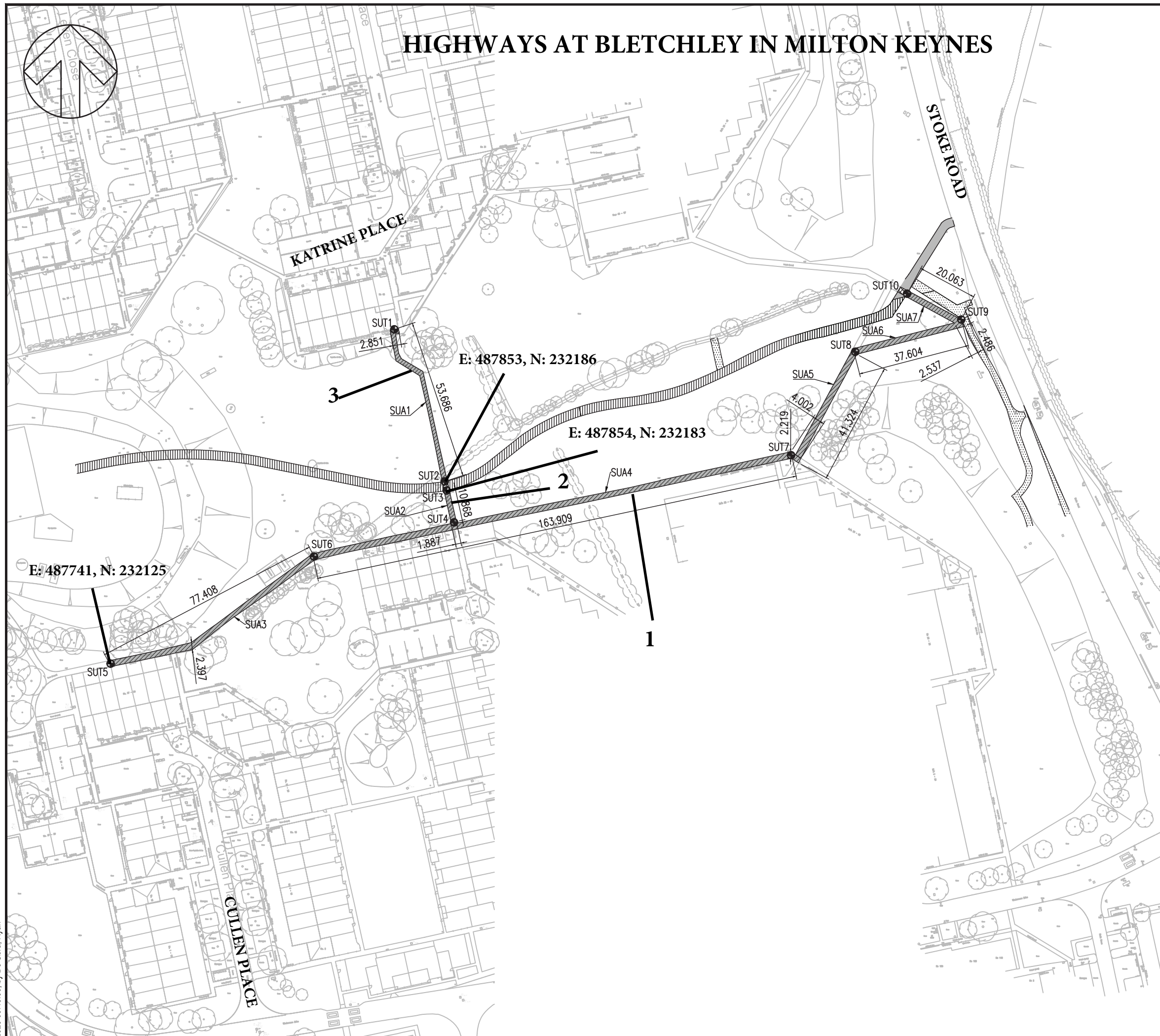

Key	Scale	1:1250 @ A3
Highways to be stopped up		
Proposed highway to be improved		
Proposed new Highway - all purpose		
Proposed footpath to be provided		
Proposed cycleway to be provided		
National Transport Casework Team		
Department for Transport		
Plan No: NATTRAN/SE/S247/5529		
Signed by Authority of the Secretary of State		
on . 26/10/2023.		
Signature... TIM BRIMELOW An Official in the National Transport Casework Team Department for Transport		

File name \\UK.WSPGROUP.COM\CENTRAL_DATA\PROJECTS\700712XX\70071234 - LAKES ESTATE REGENERATION, TENDER INFORMATION\03 DRAWINGS\03 DRAWINGS\S247 APPLICATION\MKR-WSP-11-00-DR-Y-5104.DWG, printed on 06 September 2023 09:43:00, by De Silva, Ryan